



# ECT

Pressure transmitter



## Dimensions

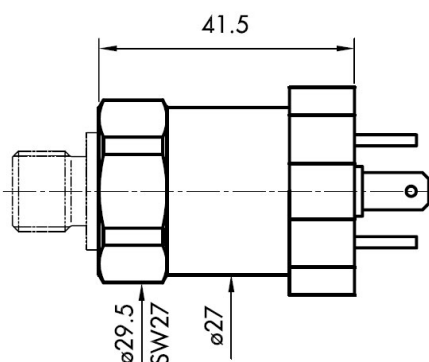

## Pressure ranges

Range (BAR)	Max. overpressure	Max burst pressure
-1,0 ... 1,0	4	5
0 ... 1,0	4	5
0 ... 2,5	6	7,5
-1,0 ... 3	6	7,5
0 ... 4	10	12
0 ... 6	15	18
0 ... 10	25	30
0 ... 16	40	48
0 ... 25	60	75
0 ... 40	80	120
0 ... 60	120	180
0 ... 100	200	300
0 ... 160	320	480
0 ... 250	500	750

## Technical data

### MAIN CHARACTERISTICS

Sensor: Thick film on ceramic  
 Measuring range: -1...1 to 0...250 bar relative  
 Signal output: 4...20mA, 0...10VDC, 0...5VDC, 1...6VDC  
 NLH (BSL through 0): ± 0.3 % FS typ.  
 Applications: Machine tools, Hydraulics, HVAC, Refrigeration, Process technology, Water treatment, Automotive, Autoclaves

### ELECTRICAL DATA

Output/Supply voltage: 4...20 mA: 24 (9...32) VDC  
 0...5 VDC: 24 (9...32) VDC  
 1...6 VDC: 24 (9...32) VDC  
 0...10 VDC : 24 (15 ...32) VDC  
 Rise time: typ. 1 ms/10...90% nominal pressure  
 Switch-on delay: 1 sec

### ENVIRONMENTAL CONDITIONS

Operating temperature: -25...+85°C  
 Media temperature: -25...+85°C  
 Protection: min. IP65  
 Humidity: max. 95% relative  
 Vibration: 4g (10...1000 Hz)  
 Shock: 50g/11 ms

### EMC PROTECTION

Emission: EN /IEC 61000-6-3  
 Immunity: EN /IEC 61000-6-2

### MECHANICAL DATA

Material Sensor: Ceramic (Al<sub>2</sub>O<sub>3</sub>) 96%  
 Housing: 1.4435 (AISI316L)  
 Process connection: 1/4" BSP male  
 O-Ring: FKM, CR, EPDM  
 Mounting torque: 15...20 Nm  
 Weight: appr. 110 g

## Electrical wiring

Protection	IP65
Execution	Industrial standard 
Output	 <b>4-20mA</b> 2 1 
	 <b>0-10Vdc, 0-5Vdc, 1-6Vdc</b> 2 3 1 



**GESINT.**  
 WWW.GESINTSRL.IT

**GESINT S.R.L.**

Via Perosi, 5  
 20010 Bareggio (MI) - ITALY  
 Tel. +39-02-90362295  
 Mobile +39-335-6282615  
 E-mail: info@gesintsrl.it